

TREK

Electric height adjustable table base

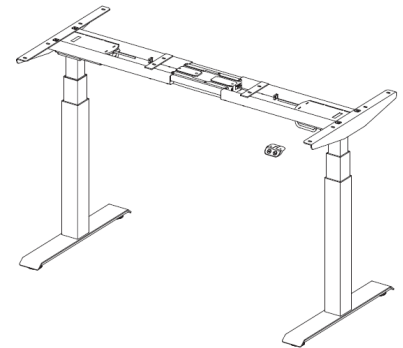

TREK Electric Height Adjustable Table Base

Elevate your space with the TREK electric height adjustable table is a great addition to any work space. Be at your best when you feel your best when you are working at the right height either sitting or standing.

- Height range- 3 stage 22.5-48.7" (calculated with a 1.25" thick work surface)
- Height range- 2 stage 27.25-46.95 (calculated with 1.25" thick work surface)
- 2 leg base structure with cross rails fits tops 40"-72" wide, 3 leg frame structure to work with up to 84" x 84" footprint
- Foot depth of 22" and 28" both 24" and 30" deep tops
- Premium Gyrocontrolled Anti Collision programming
- Programmable 3 position memory hand control with additional features
 - Program up to 3 unique desk height positions and activate with 1 touch control
 - Set new low and high position stop points to avoid the table base from contacting file pedestals or shelves in your work space
- Weight rating 220 lbs for 2 leg and 300 3 leg
- Speed 1.4" per second, with whisper quiet motors
- Individual motor in the top of each column
- 100-240V, low standby power consumption
- Warranty 5 years on electronics and 10 years on structural components
- ANSI/BIFMA X5.5-2014, and UL Certified
- C leg available



Part No.	Description
TREK-3S-(or 2S) 2L30T ** or 24T	TREK 2 leg electric table frame Silver White or Black
TREK-3S-(or 2S) 3L30T ** or 24T	TREK 3 leg electric table frame Silver White or Black



TREK QUICK INSTALL BASE FRAME



Efficient and Intelligent

Fast Installation Options

TREK provides desk frames with quick installation design which integrates exquisite, intuitive, concise and efficiency, making it easier to assemble an adjustable desk and allowing customers to experience the ultimate charm of industrial aesthetics design. It can save at least 50% of the installation time and reduce the labor cost for desk frame installation, comparing with traditional designs.

3-step Quick Installation (0 screws)

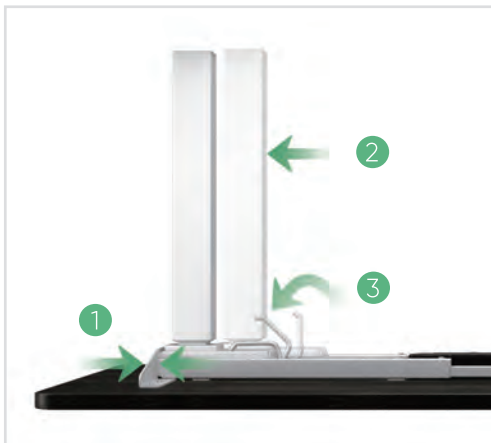

- 1 Simply clamp the side beam and cross beam together
- 2 Push the leg toward the side beam to secure them naturally

- 3 Exquisite and unique Plug & Lock design that perfectly tightens the legs to the frames

